



Technical Data

Electrical Data	
Supply Voltage	11...30 V DC
Current Consumption (U _b = 24V)	150 mA
Temperature Range	0...45 °C
Short Circuit Protection	yes
Reverse Polarity Protection	yes
Mechanical Data	
Housing	Plastic
Weight	300 g
Protection Mode	IP 24
Connection RS-Side	SubD 9 S
DIN-Rail mounting	35 mm

- Easy Handling
- Gateway from RS-232 / RS-422 Interfaces on Profibus DP, CAN Open, Ethernet 10 BaseT and Interbus
- Modular Design

These Fieldbus Gateways allow an easy connection of Sensors and Barcode Scanners to various Fieldbus Systems.

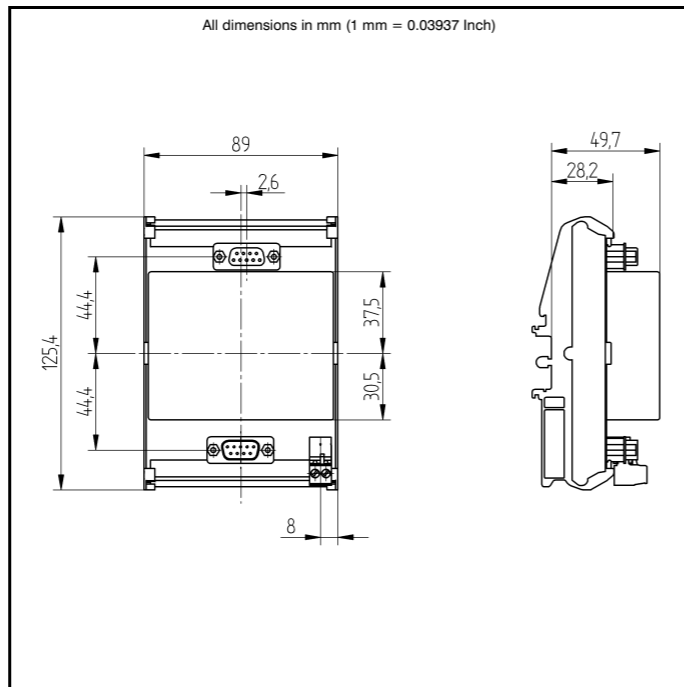

Specifications are subject to change without notice
46/05



	Plug Version			
	AB-PRO01	AB-CAN01	AB-ETH01	AB-INT01
Part Number	AB-PRO01	AB-CAN01	AB-ETH01	AB-INT01
Profibus DP	●			
CAN Open		●		
Ethernet 10 BaseT			●	
Interbus				●
Baud Rate	< 12 MBd	< 1 MBd	< 10 MBd	< 500 kBd
Number of Bus Clients	126	32	512	256
Connection Bus Side	SubD 9 B	SubD 9 S	RJ45	SubD 9 S/B