

Glass Fibre Optic Cable Curtain for Analogue Universal Sensors



Rw ≤ max 700mm

Range



- For Measuring Applications
- Variable Slit Length
- High Temperature Resistance

Glass fibre optic cable curtains function in accordance with the through-beam sensor principle. The fibres are arranged in a single line. A luminous row is thus created between the transmitter and the receiver. If these fibre optic cable curtains are used in combination with an analogue universal diffuse light sensor (UF22MV3, UF55MV3), the length of the slot corresponds to the analogue range. The sensors' analogue output voltage is proportional to the obstructed portion of the light slot. If a universal diffuse light sensor with switching output is utilised (UF88PA), the switching point can be adjusted such that the output is switched when the light slot is obstructed to a defined extent.



Technical Data

Opening angle	68°
Fibre	Stepped index
Fibre diameter	50µm
Fibre	statistic mixture
Bending radius	
Jacket Ø 6,7	60mm
Jacket Ø 8,2	70mm
Ambient Temperature	-25°C...+300°C
Jacket	Brass Nickel - Plated
Material of the endpoint	Aluminium
Adapter	1
Length of the fibre optic	1m

Order number	Standard stock items				
403270104	363271104	363272104	363273104	303274104	
Rw with sensor type					
UF55MV max.	700mm	600mm	600mm	600mm	500mm
UF55MV min.	150mm	130mm	130mm	130mm	110mm
UF22MV max.	300mm	250mm	250mm	250mm	200mm
UF22MV min.	60mm	50mm	50mm	50mm	40mm
Fibre bundle diameter	4,0mm	3,6mm	3,6mm	3,6mm	3,0mm
Endpoint	70	71	72	73	74

Glass Fibre Optic Cable Curtain

for Analogue Universal Sensors

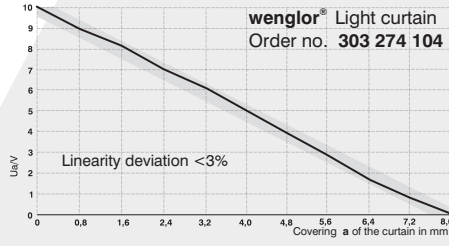
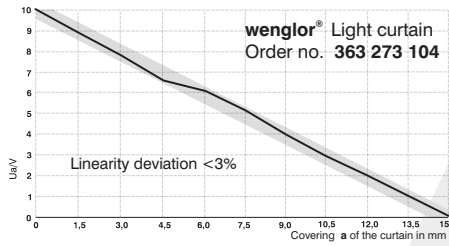
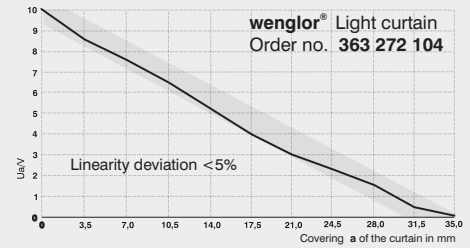
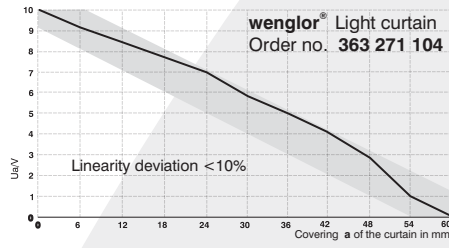
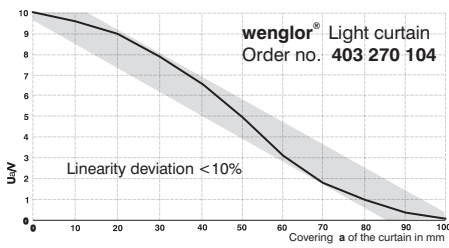

Covering of the Light Curtain (Prinzip)

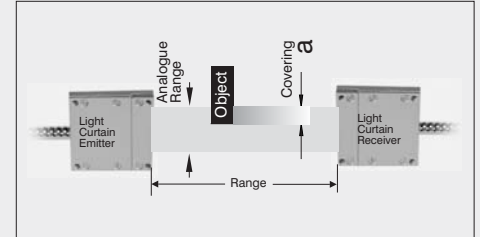

403270104

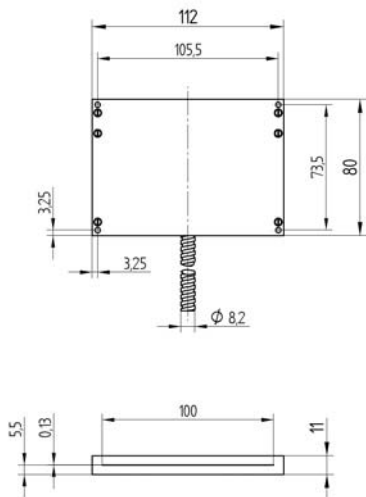

363271104



363272104

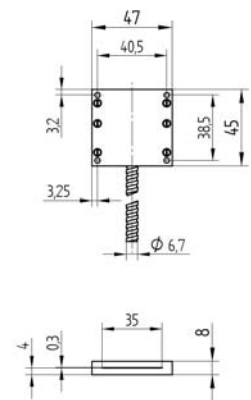

363273104

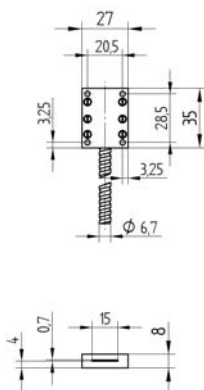

303274104

