

RELIABLE AND TORSIONALLY RIGID

BELLOWS COUPLINGS

SERIES BK 8 | 15 – 2,600 Nm



R+W[®]
COUPLING TECHNOLOGY

THE ULTIMATE COUPLING FROM 15 – 2,600 Nm

www.rwcouplings.com

MODEL BK 8

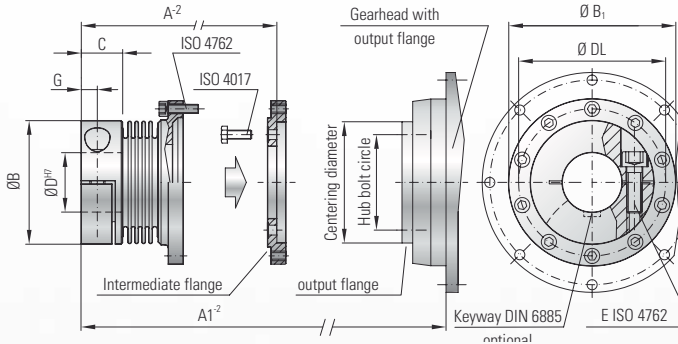

BACKLASH FREE BELLOWS COUPLING



Ordering example

BK8 / 15 / 24 / 40 / XX

Model
Series
Bore $\varnothing D$ H7
Flange centering diameter
non Standard eg. stainless steel

Model BK 8		Series				
		15	60	150	300	1500
Flange centering diameter (mm)		40 h7	63 h7	80 h7	100 h7	160 h7
Flange bolt circle / thread \varnothing (mm)		31.5 8x M5	50 8x M6	63 12x M6	80 12x M8	125 12x M10
Max. torque* (Nm)		50	210	380	750	2600
Length -2 (mm)	A	49	67	72	90	140
Length -2 (mm)	A ₁	68	97	101	128	190
Outer diameter (mm)	B	49	66	82	110	157
Flange diameter (Nm)	B ₁	63.5	86.5	108	132	188
Fit length (mm)	C	16.5	23	27.5	34	55
Inner diameter possible from \varnothing to \varnothing H7 (mm)	D	12-28	14-35	19-42	24-60	50-80
Hub bolt circle (mm)	DL	56.5	76	97	120	170
Fastening threads (kg)		10 x M4	10 x M5	10 x M6	12 x M6	16 x M8
Fastening screws ISO 4762		1 x M5	1 x M8	1 x M10	1 x M12	2 x M20
Tightening torque (Nm)	E	8	45	80	120	470
Distance (mm)	G	6.5	9.5	11	13	22.5
Approx. weight (kg)	I	0.3	0.7	1	2.8	10
Moment of inertia (10^{-3} kgm ²)	J _{ges}	0.15	0.65	1.3	5.5	45
Lateral  (mm)	Max. value	0.15	0.15	0.15	0.18	0.2
Angular  (Grad)		1	1	1	1	1
Axial  (mm)		1	1.5	2	2.5	3

*max. torque transmittable for a short-term period on max. diameter (D).



Flange mounting

Properties:

- zero backlash and high torsional rigidity
- easy assembly
- suited for space restricted installations
- compact design

Material:

The hubs are made of aluminium, series 300 and 1500 made of steel. Bellows are made of highly flexible, high-grade stainless steel. Intermediate flange made of steel (standard).

Design:

One side with a clamping hub and a single radial clamping screw ISO 4762.
One side with a flange-connection and a separate intermediate flange.

Speed:

Up to 10,000 rpm.

Temperature range:

-30 to +120° C (3.6 F to 270)

Fit tolerance:

On the hub/shaft connection 0.01 to 0.05 mm.

Non standard:

Custom designs with varied tolerances, keyways, non-standard material and bellows are available upon request.

Gearhead with output flange

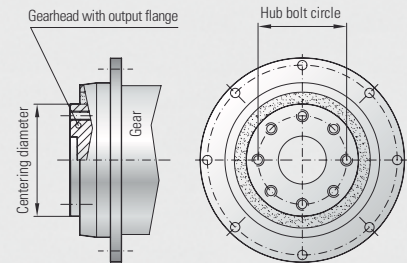

The bolt circle will be drilled acc. to the gear head

Mounting and dismounting

